

John Mifflin Jonathan Meredith

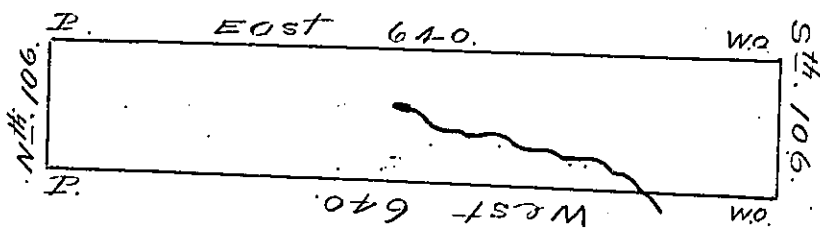

The above is the draught of a survey made Decem-
 ber 9th 1794 in pursuance of a warrant granted to -
 Jonathan Mifflin on the 14th day of April 1792 - Situate
 Northwest of the Ohio river on the waters of Beaver
 Creek adjoining land granted to John Mifflin -
 called Galicia containing 400 acres with the
 usual allowance of 6 per Cent for

J. Hoge D.S.

Daniel Brodhead Esq. S.G.

IN TESTIMONY that the above is a copy of the original remaining on file in
 the Department of Internal Affairs of Pennsylvania, made
 conformably to an Act of Assembly approved the 16th day of
 February, 1833, I have hereunto set my Hand and caused
 the Seal of said Department to be affixed at Harrisburg,
 this twenty seventh day of November 1905.

Loac P. Brown
 Secretary of Internal Affairs.